



**SF-CIERRAPUERTAS
UNIVERSAL
40 - 120Kg.**

Poligono Industrial Foradada - 08580 - Sant Quirze de Besora (Barcelona)
Telf. 34-93.852.92.23, Fax.34-93.852.91.59
Export. Telf. 34-93.852.96.15, Fax.34-93.852.91.76
e-mail: saheco@saheco.com - web: www.saheco.com

MADE IN E.U.

**GRUPO
TORREMAT**



JULY - 2017

038060491

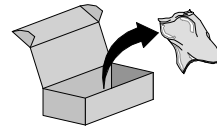

008090

a		1	f		3m.	1
b		1	g		3m.	1
c		1	h			1
d		1	i		3x25	1
e		6	j		3,5x16	2
			k		3x12	13

1

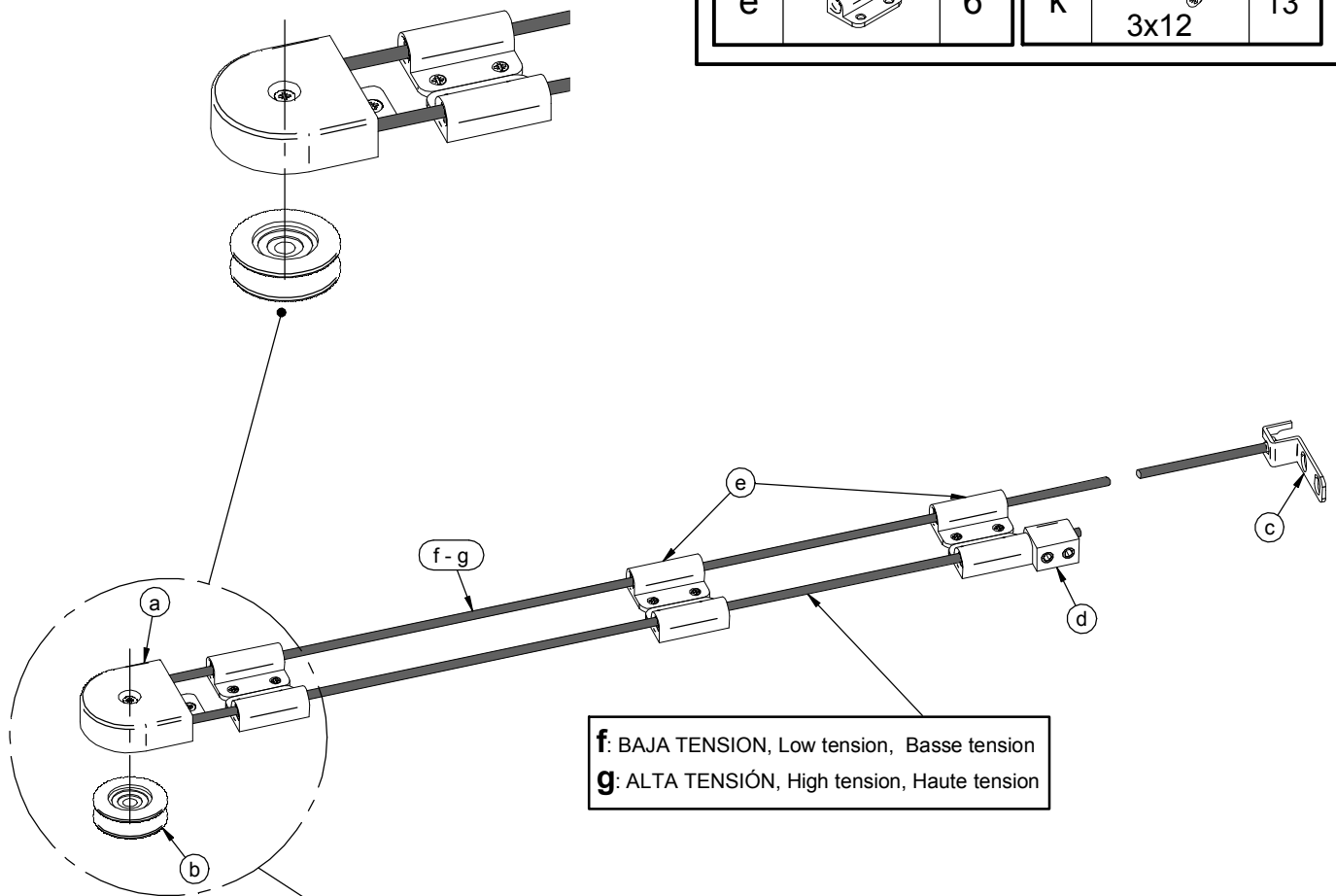

COMPATIBLE

SOFTBRAKE:
CODE: 006782, 098082, 098083

PERFILES / Profiles / Profils:
STANDARD SF-A60/A80/A100/A125
EXCELLENCE
ROLLER
SF-40/75

