

1 CORTE PERFILES / Door profile cutting

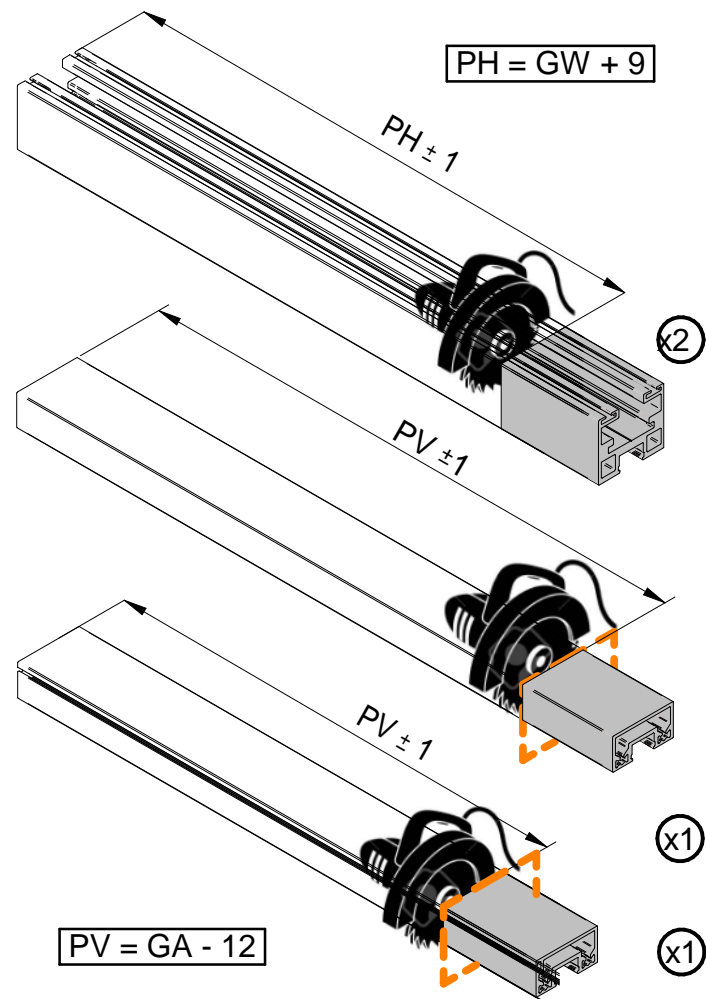

IMPORTANTE CORTAR PERFILES DESPUES DE MEDIR EL VIDRIO / It's important to cut the profiles after measuring the glass

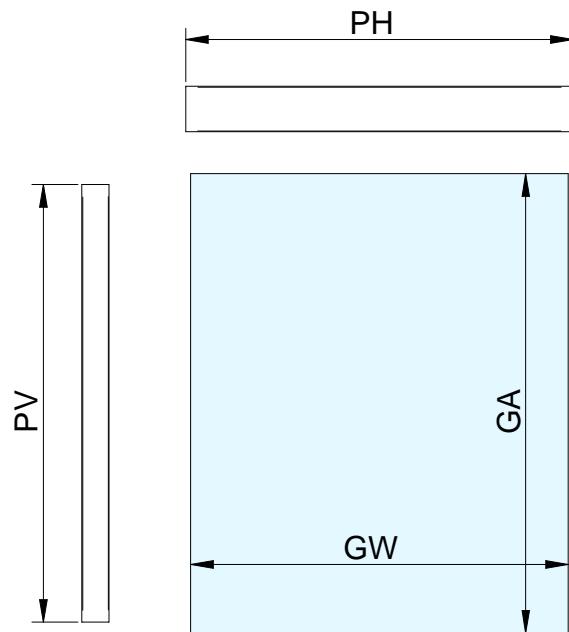

2 MECANIZAR PERFILES / Machine profiles

2.1

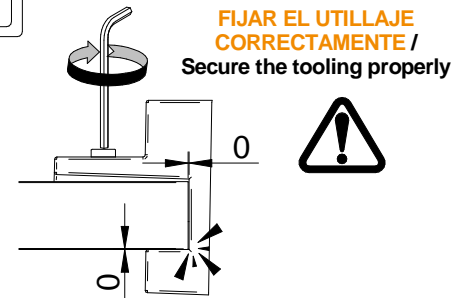
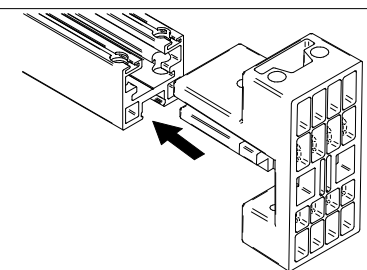

2.2

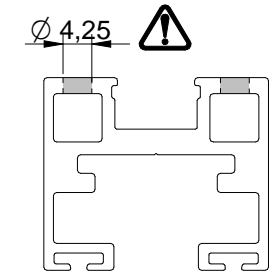
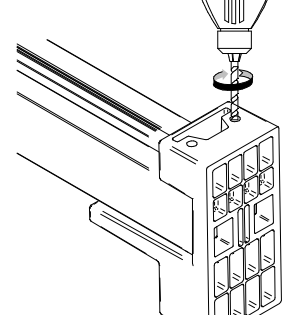

2.3

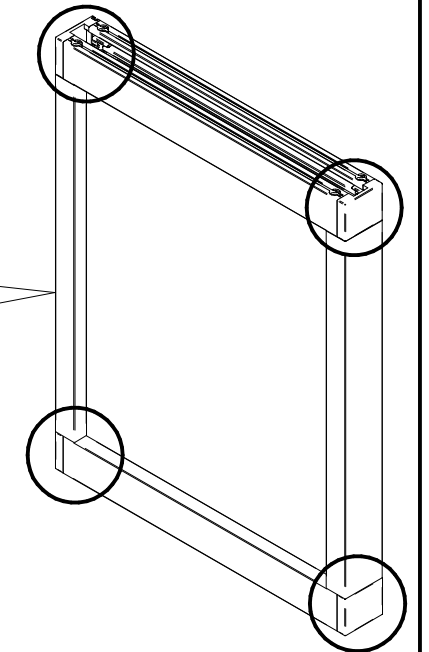
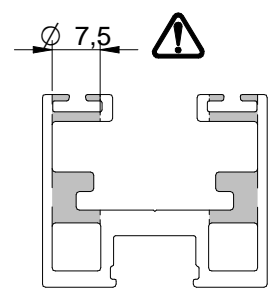
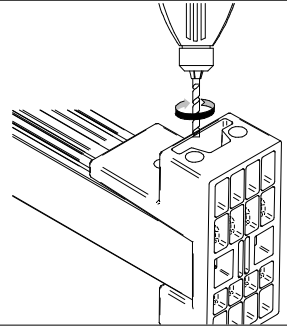

3 SILICONAR JUNTAS AL MARCO / Silicone joints to frame

Seleccionar junta segun espesor vidrio (F):

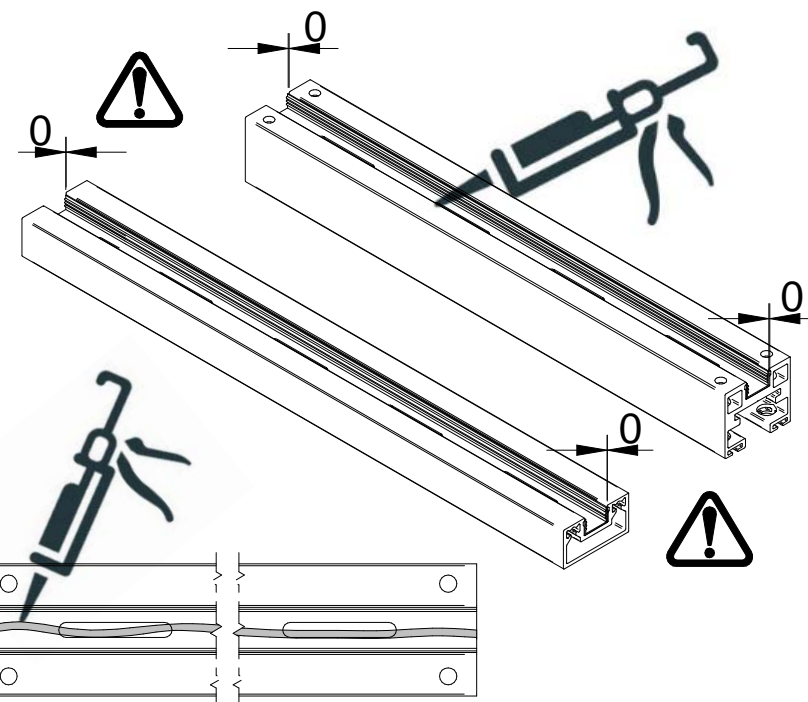
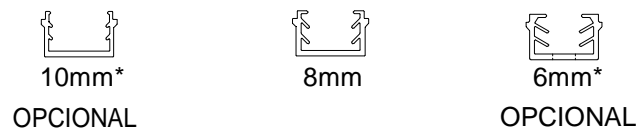

4 MONTAJE MARCO / Door frame assembly

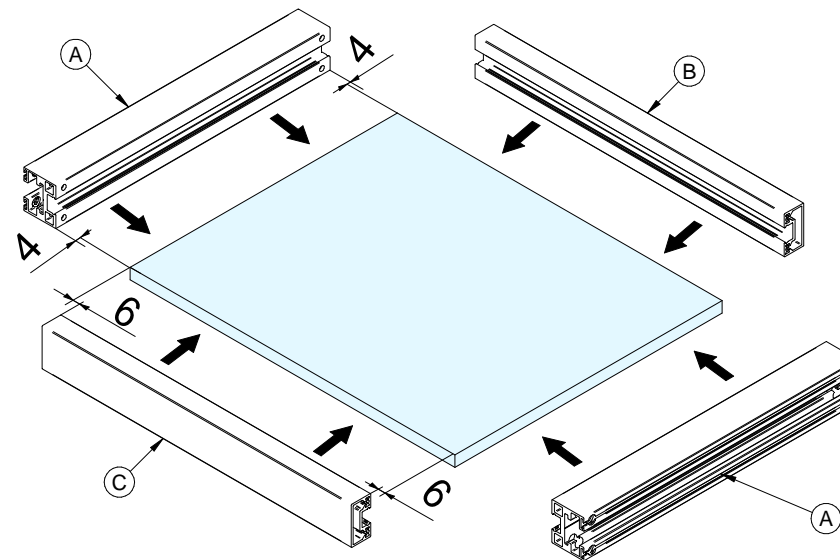

EVITAR EL PANDEO DEL VIDRIO / Avoid glass deflection

5 ATORNILLAR Y ASEGURAR EL MARCO / Screw and secure the frame

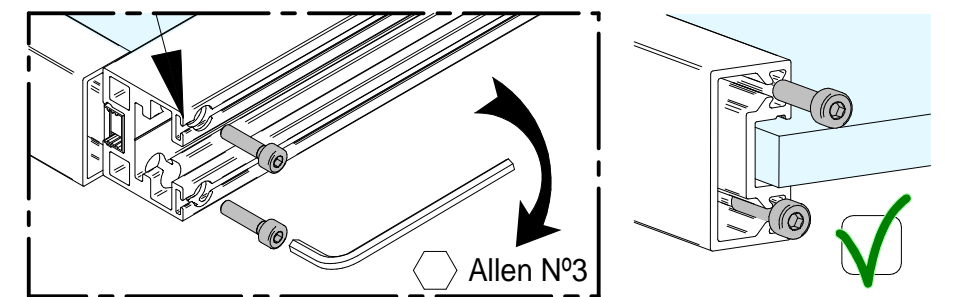
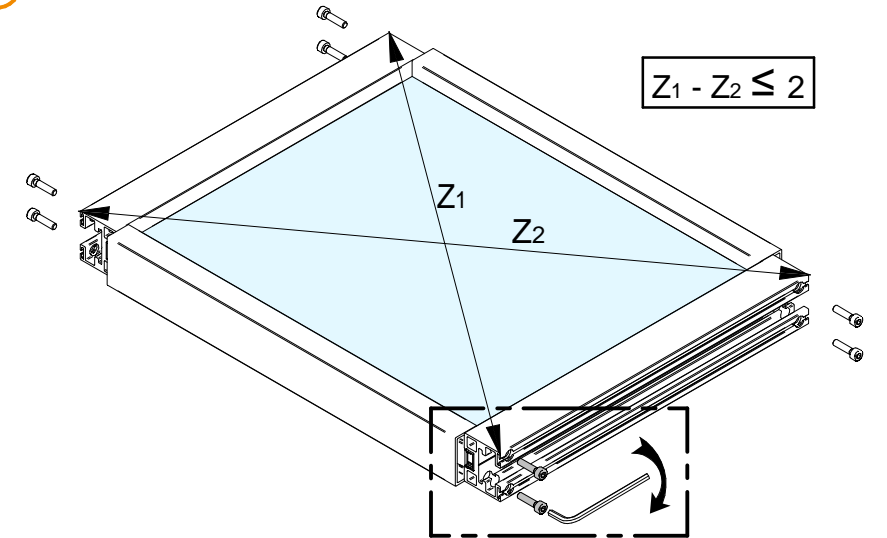

⑥ MONTAJE COMPONENTES PUERTA CORREDERA / Assembly components for sliding door

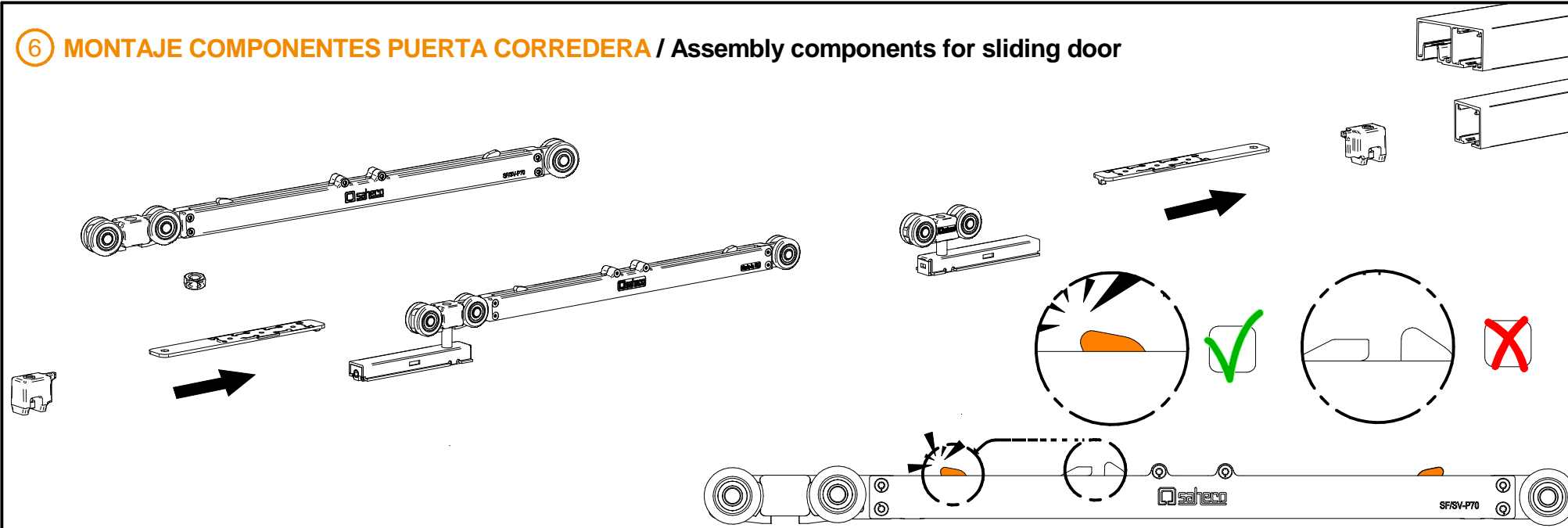

⑥A MONTAJE COMPONENTES PARA VIDRIO FIJO / Assembly components for fixed glass

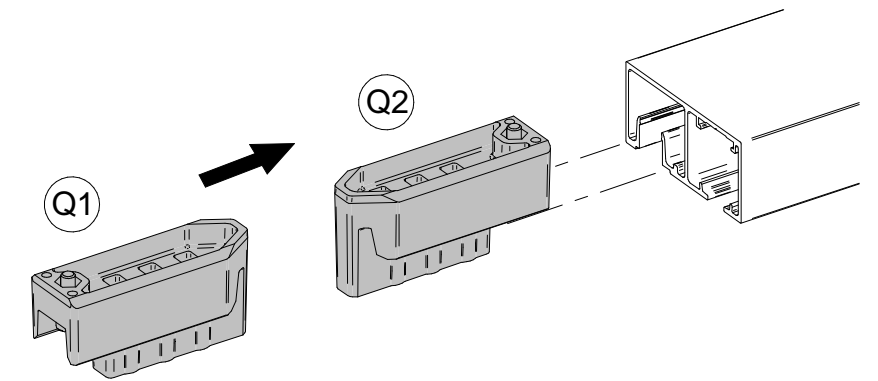

⑦ FIJAR TOPE MECANICO / Stopper

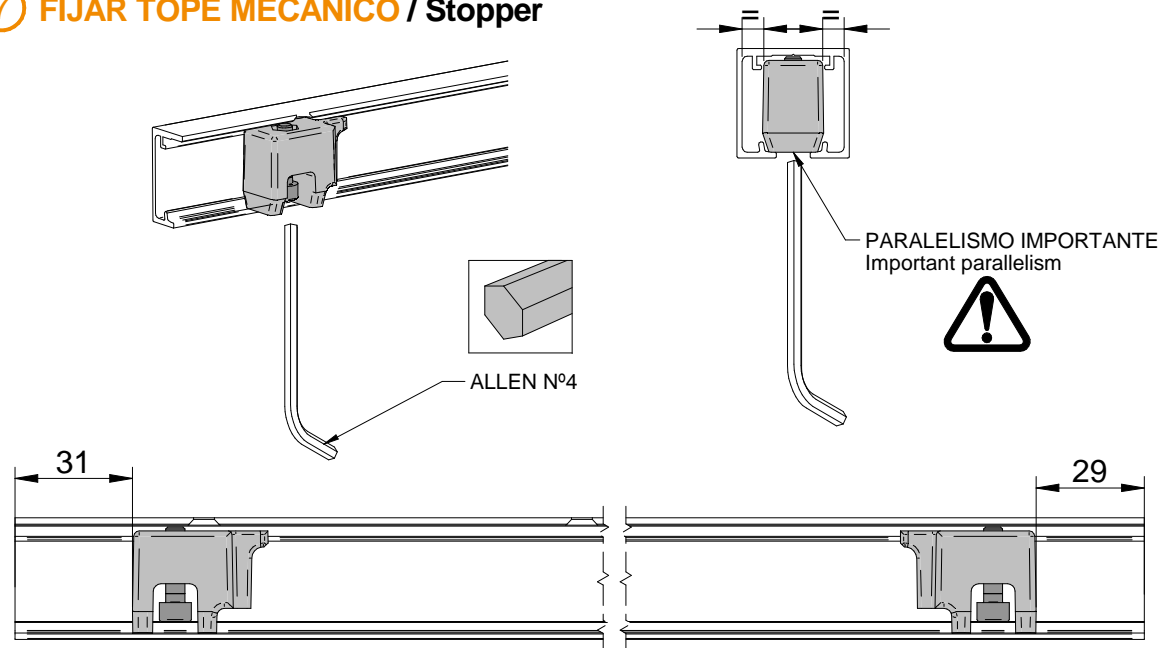

⑧ MONTAJE ACTIVADOR / Assembly activator

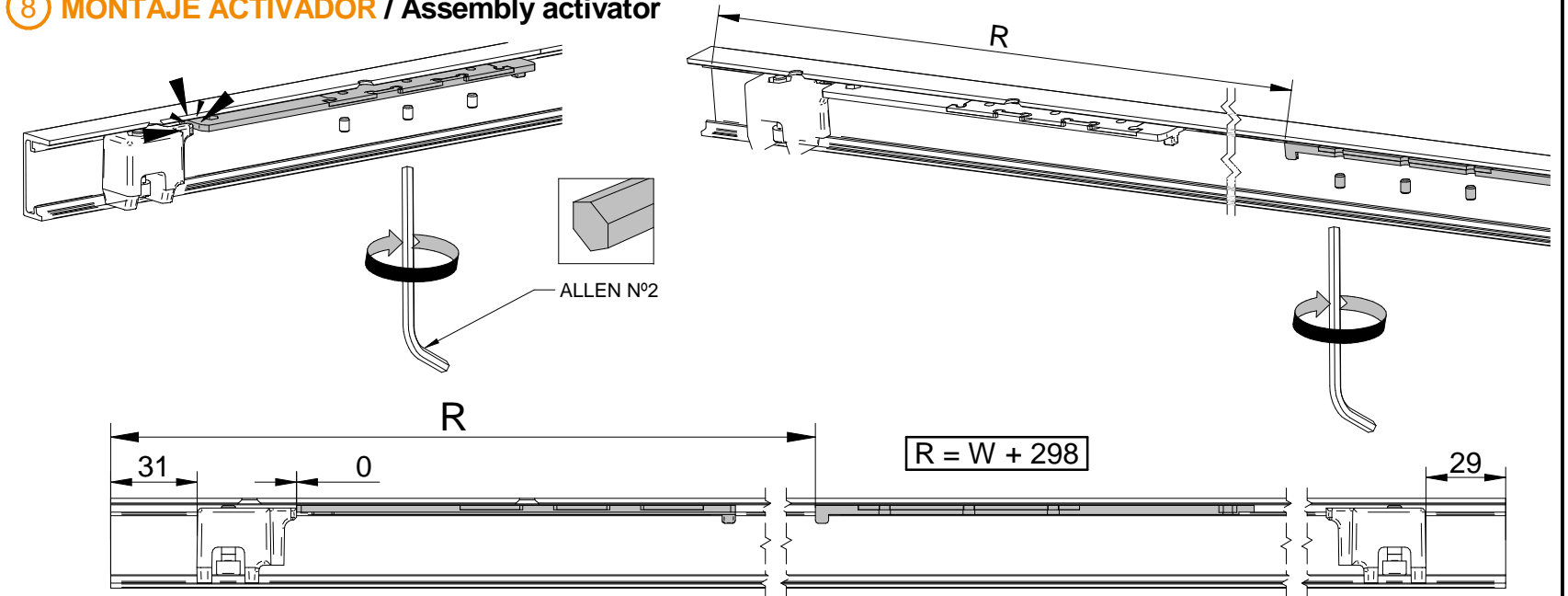

⑨ MONTAJE A TECHO / Ceiling mount

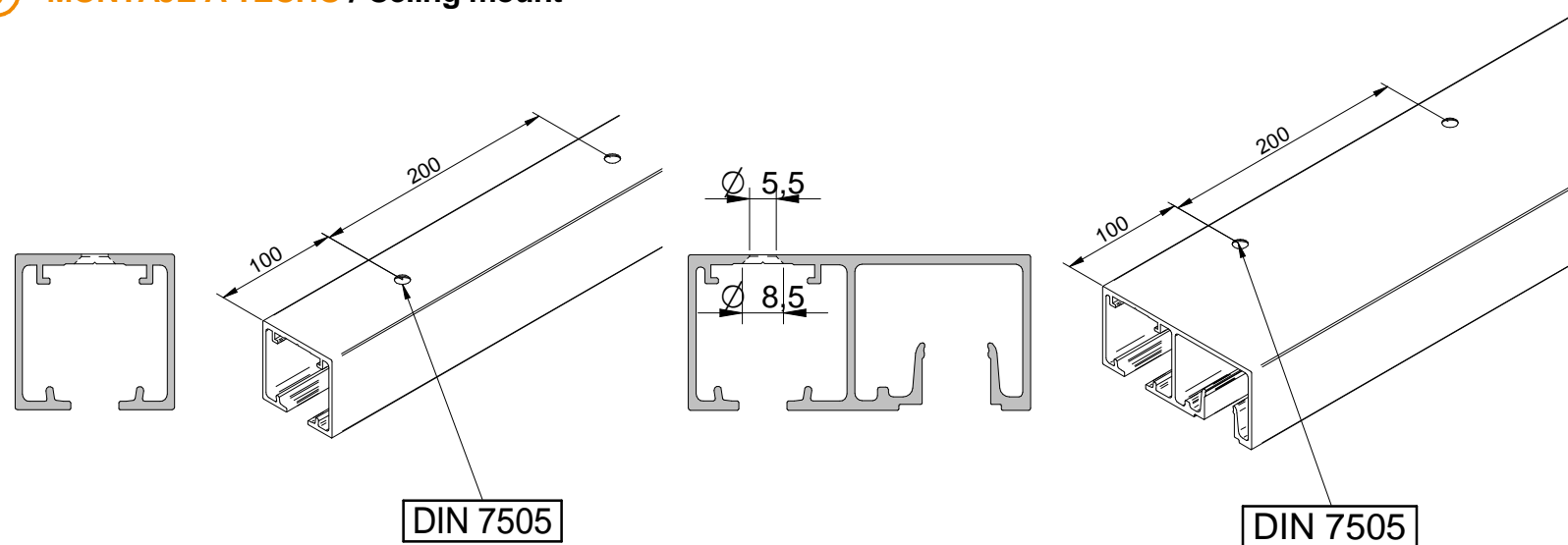

⑩ MONTAJE A PARED + SEPARADOR / Wall Mount + Full Length Separator Track

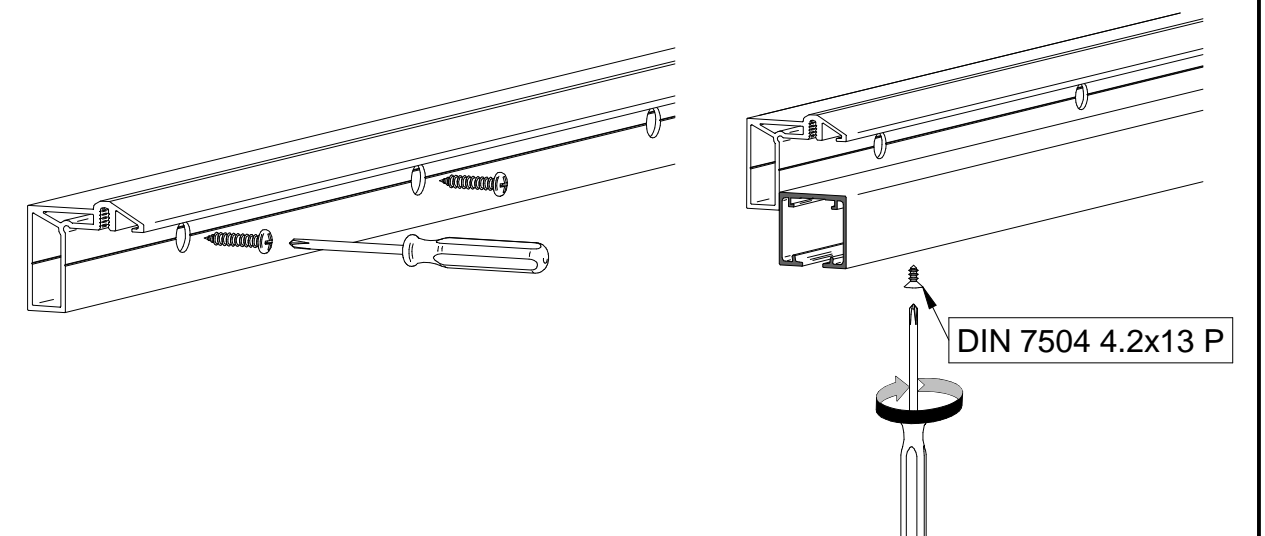

11 MONTAJE GUIADOR / Bottom guide assembly

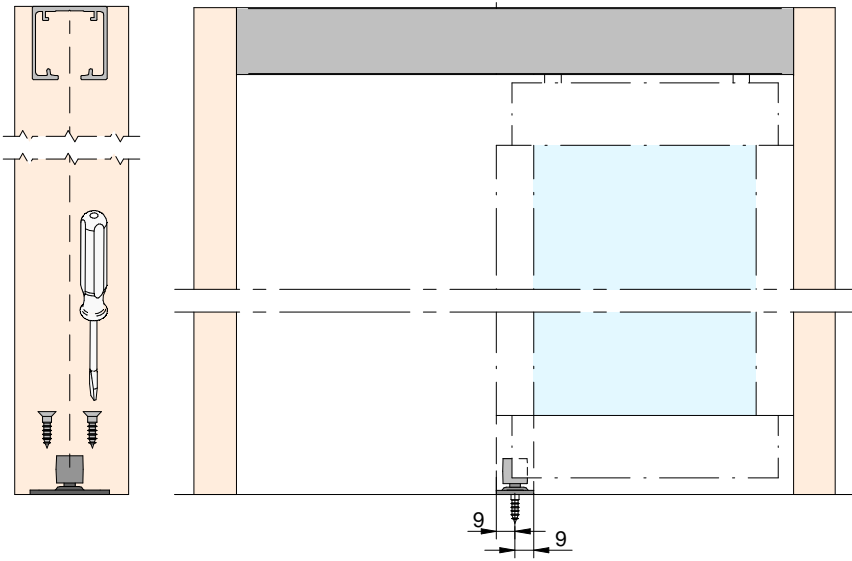

12 POSICIONAR PUERTA / Align the door



INSTALE LA PUERTA CON LA RANURA PARA LA JUNTA CEPILLO COMO SE INDICA EN LA IMAGEN
Install the door ensuring the slot for the brush seal is positioned as shown in the image

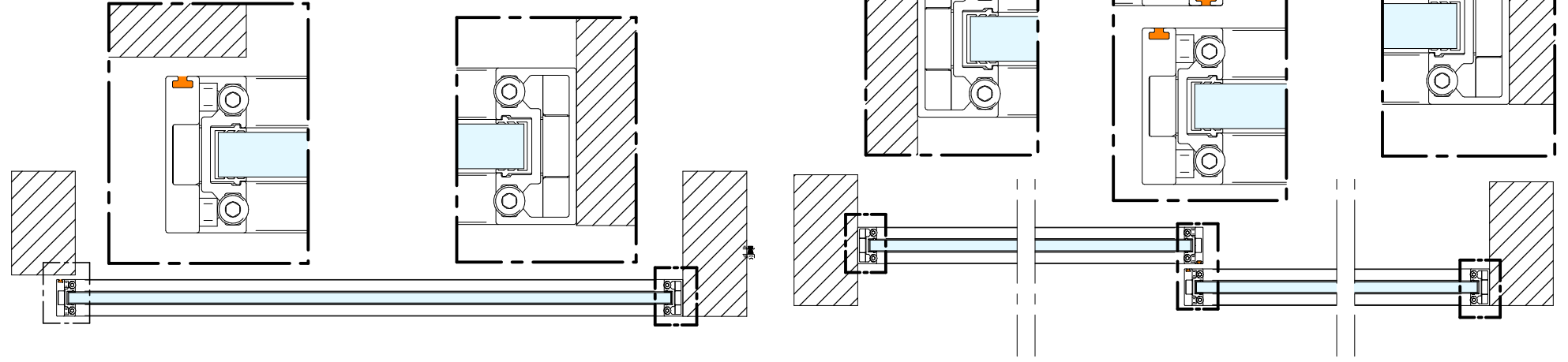

13 INSTALAR Y ASEGURAR LA PUERTA CORREDERA / Install and Secure the Sliding Door

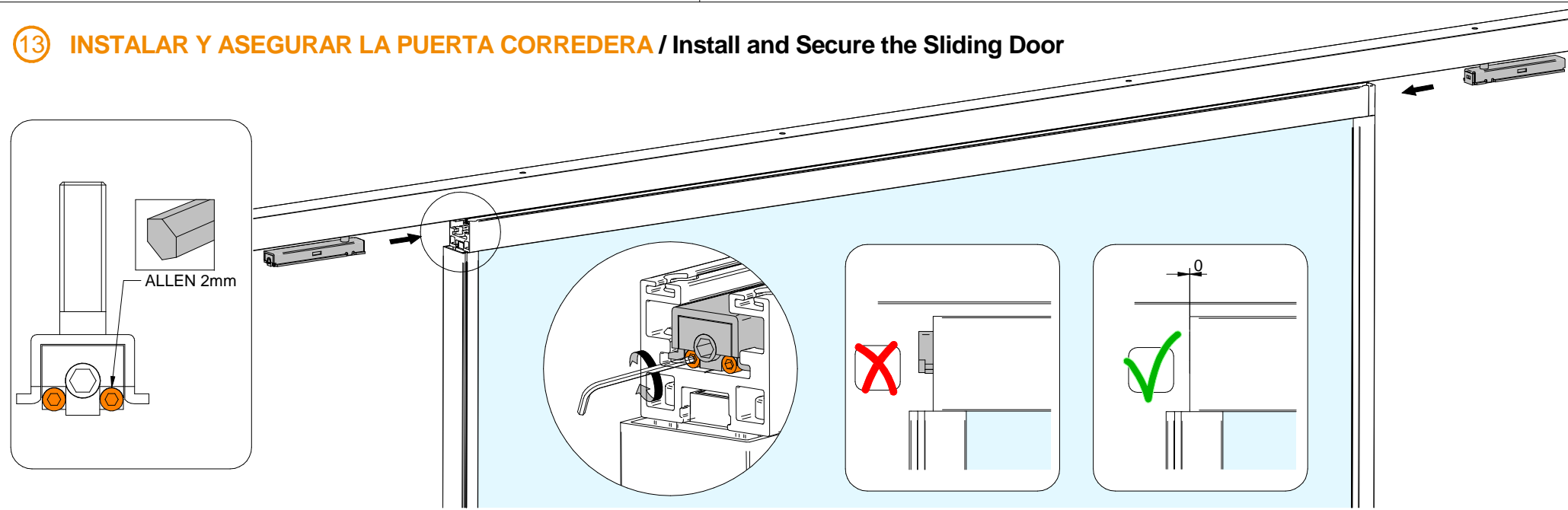

14 REGULACIÓN PUERTA / Height adjustment

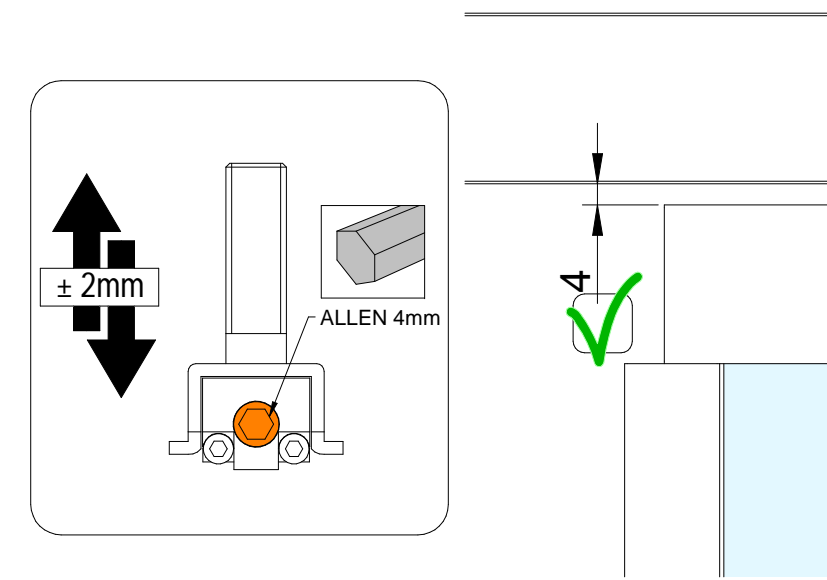

15 MONTAJE FELPAS / Weatherstrip assembly

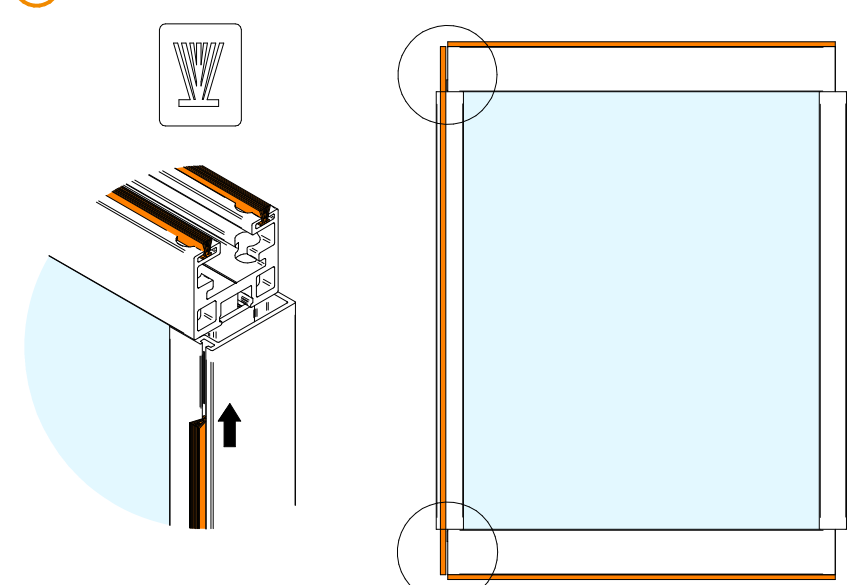

16 MONTAJE TAPETAS / End caps assembly

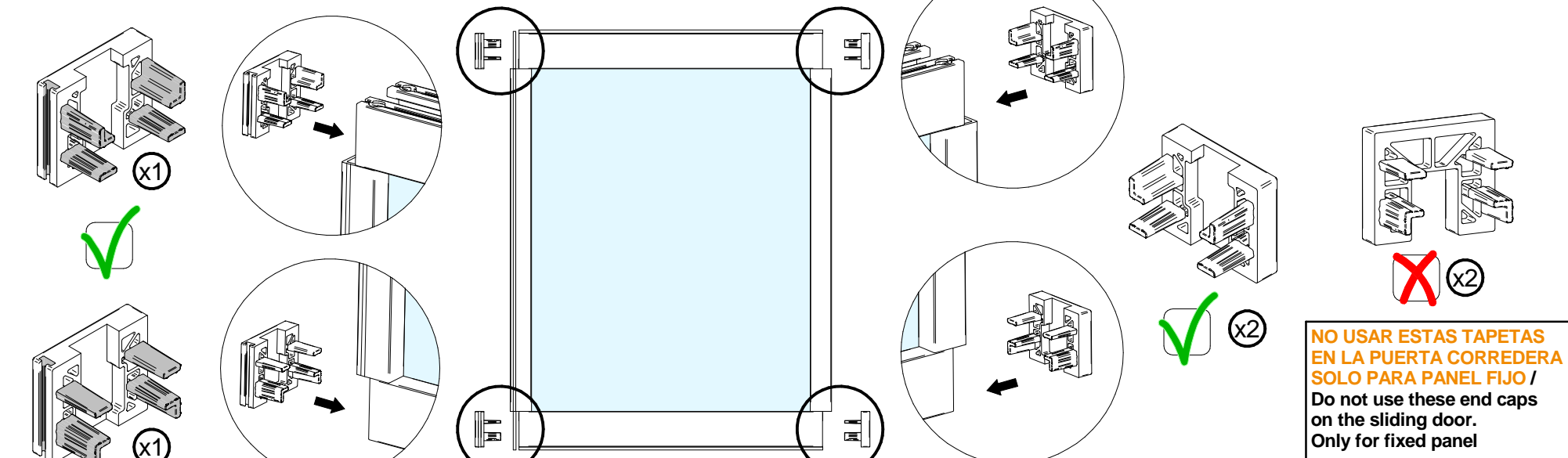

OPCION MONTAJE PUERTA FIJA / Fixed door mounting option

17 MONTAJE PERFIL INF. VIDRIO FIJO / Bottom track for fixed glass

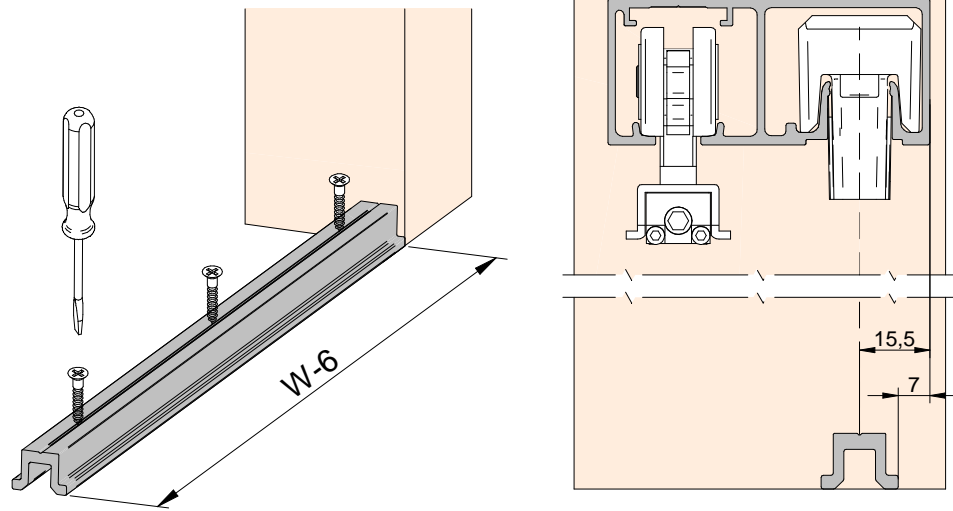

18 MONTAJE ACESSORIOS VIDRIO FIJO / Fixed glass accessories assembly

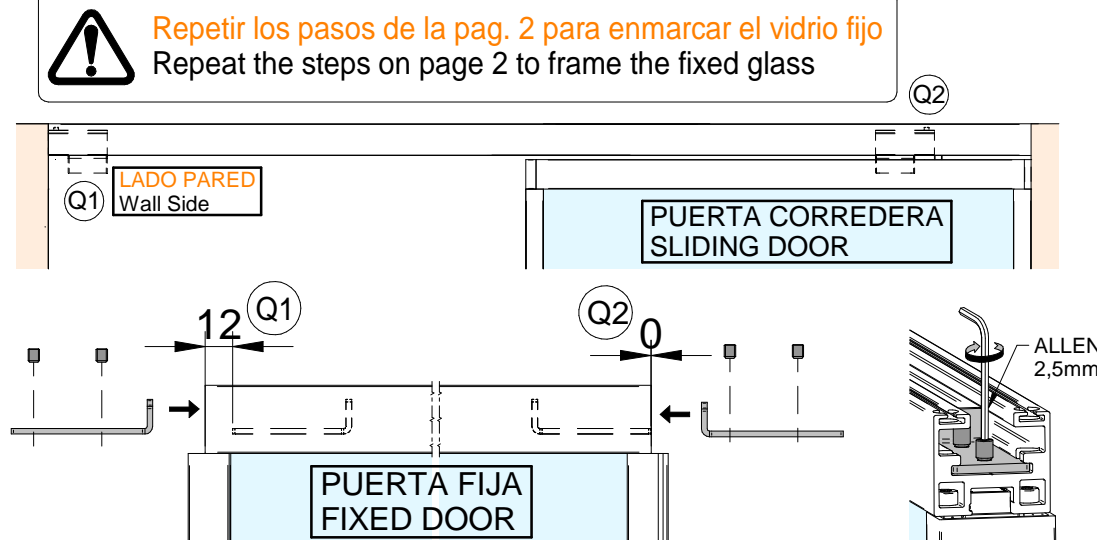

19 MONTAJE TAPETAS LADO PARED / End caps assembly on the wall side

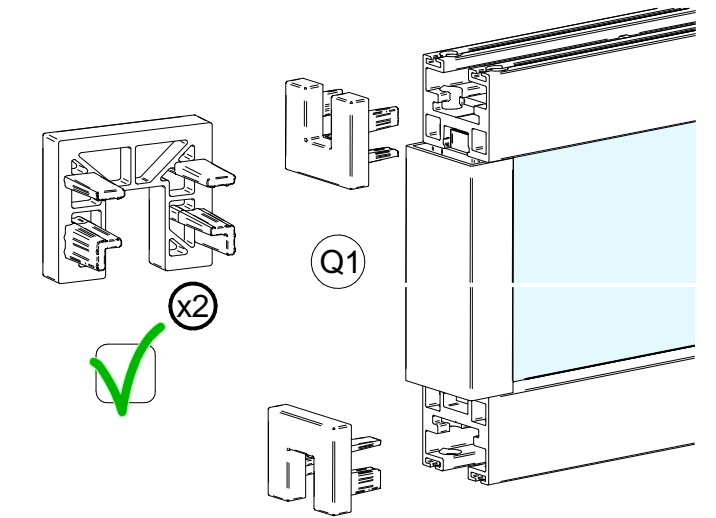

20 MONTAJE PUERTA FIJA / Fixed door assembly

20.1 FIJAR TOPE Q1 / Fix the Stopper Q1

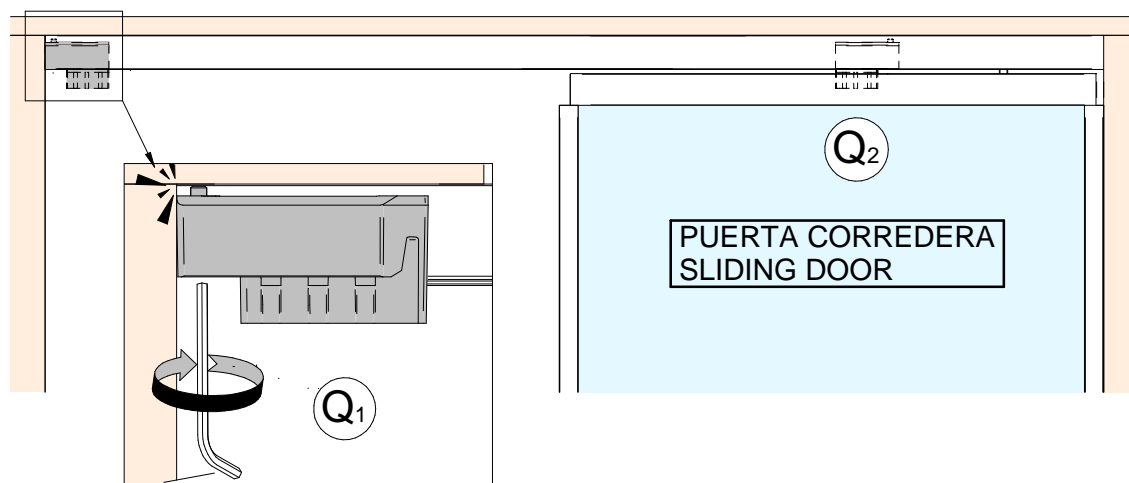

20.2

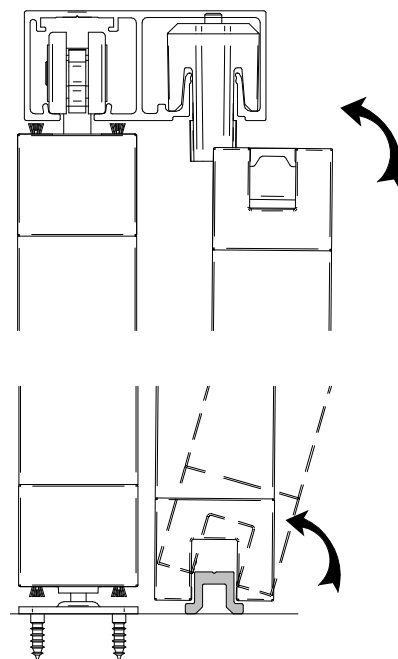

20.3 DESLIZAR LA PUERTA FIJA / Slide the Fixed door

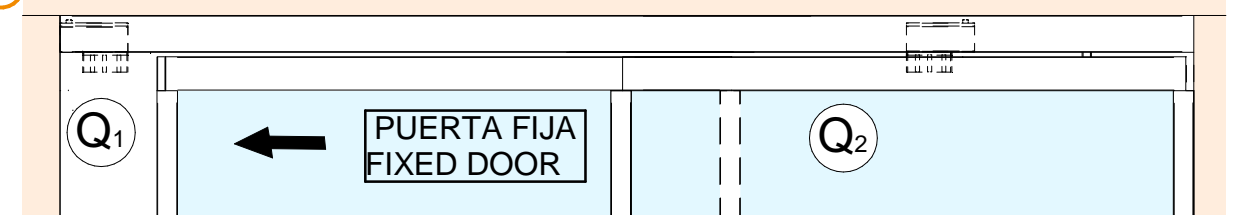

20.4 DESLIZAR Y FIJAR TOPE Q2 / Slide and Fix the Stopper Q2

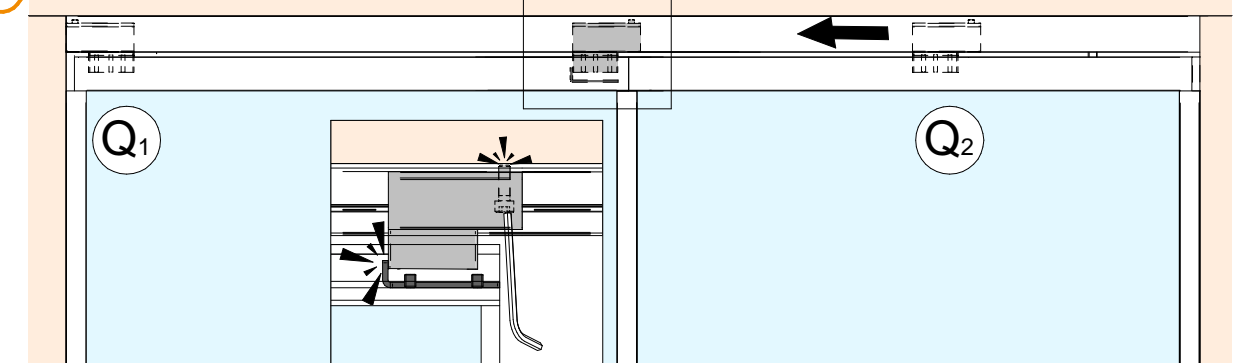

21 NIVELAR / Level

Grueso (mm)	X (mm)
12	6
13	5
14	4
15	3
16	2

GRUESOS NIVELACION / Level thickness

22 MONTAJE FELPAS / Assembly the covers

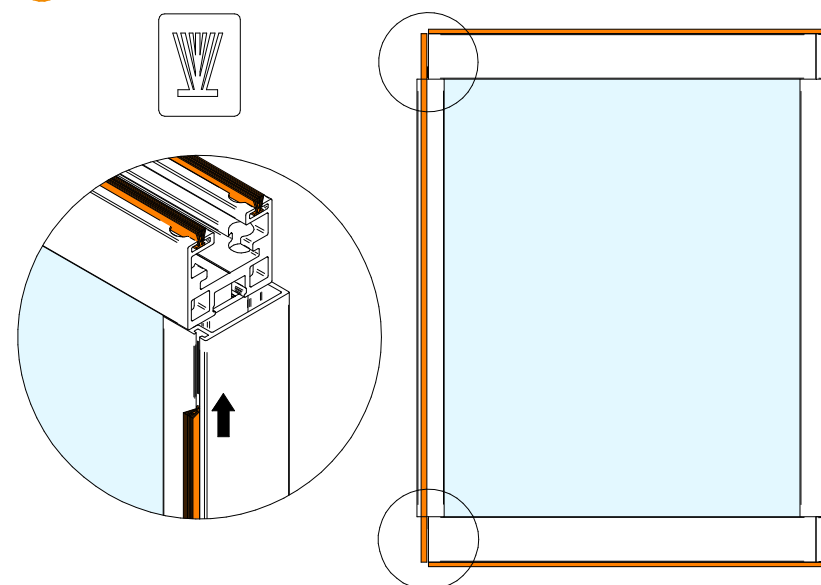

23 MONTAJE TAPETAS / End caps assembly & Fixed Glass Trim Cover

